

# SURVEYOR'S RECORD

Section 6

Township 106

Range 41

6  
7

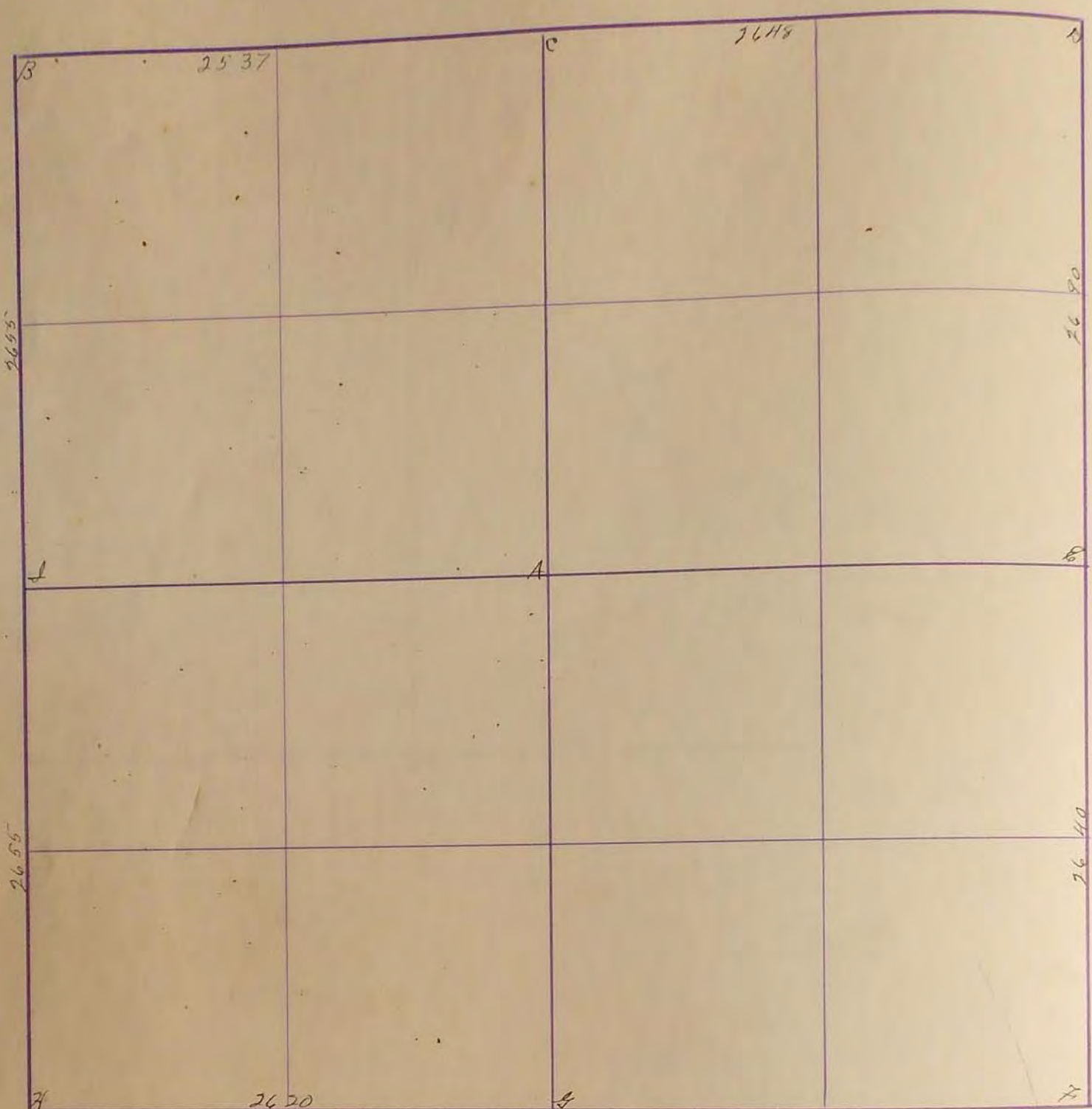

Oct. 24 1891

1968

- A. Stone & Cuts
- B. Township Corner
- C. stone east of trees about 6'
- D. stone east of grade 12X16X24
- E. stone in road
- F. stone in grade
- G. Gov. mound City & state
- H. stone in road
- I. stone
- Gov. stake B.F.S.
- Stakes marked by previous survey B.D.E.F.
- Established A.H.I.

- E. Iron Rod. R.P. Nail & Cap P.P.
- NW. 54.20' R.P. Not on Apron NE - 48.30'
- SE - 47.00'
- D. Iron Rod R.P. Nail & Cap T.P.
- NW 59.40' R.P. Not on Apron
- NE - 47.65'
- SE - 46.25'

J.H. Woodstone of T

SURVEY No. 1111

Section 6 Town 106 Range 41

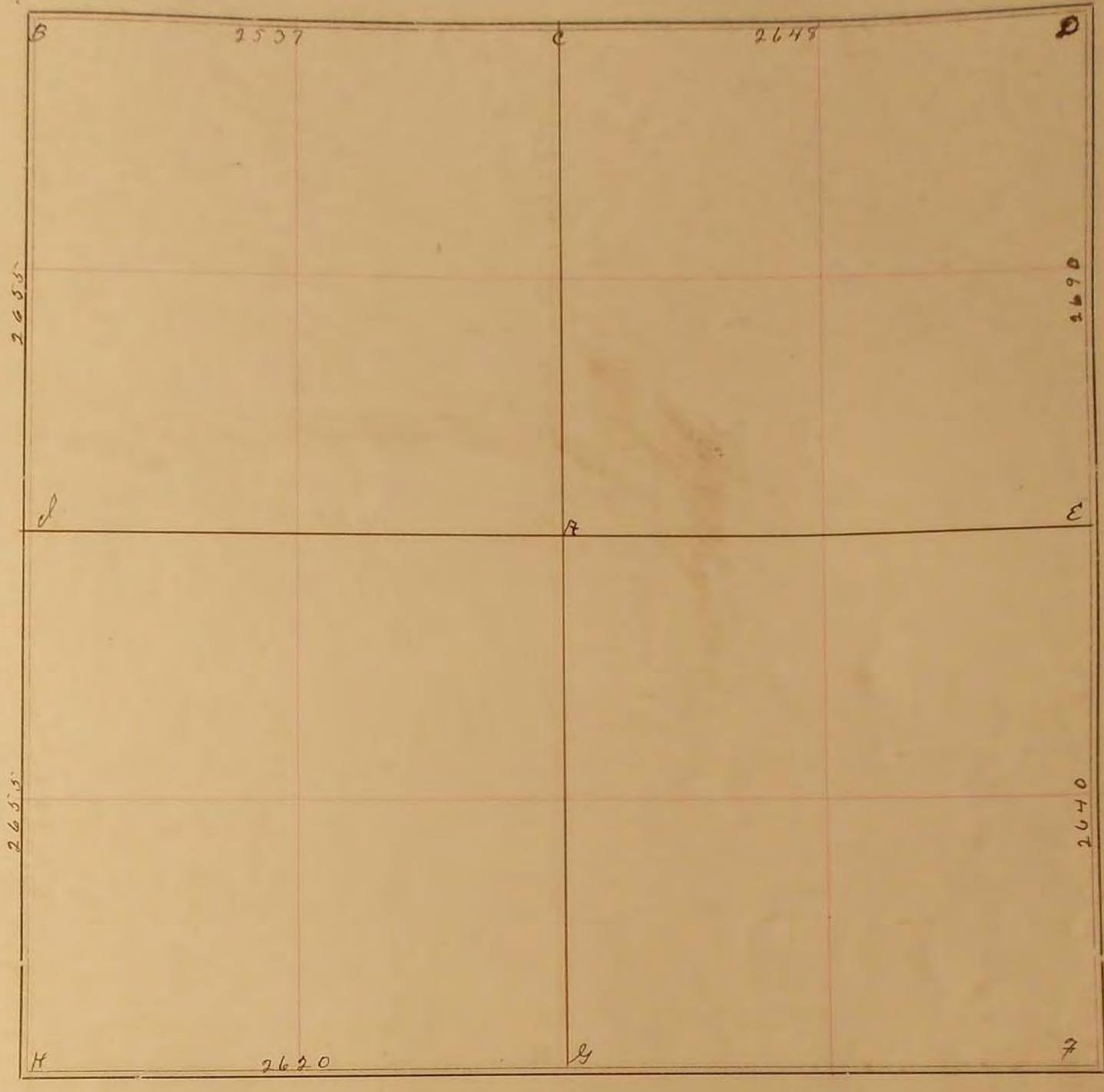

FIELD NOTES.

Oct 24, 1891

- A Stone + pits
- B Township corner
- C Stone east of trees about 6'
- D Stone east of grade 12x16x24
- E Stone in road
- F Stone in grade.
- G Gov. mound, pits + stake
- H Stone in road
- I Stone
- Gov. stakes B, F, G.
- Stakes marked by previous survey B, D, E, F.
- Established A, H, I.

J. W. Woolstenhulme